



Friends of the Wade

The Marion E. Wade Center Wheaton College

Breaking Ground at the Wade

On April 3rd, all the talk at the Wade Center was about the weather. The Wade staff tuned its collective ear to the forecast, and Wheaton College Provost Dr. Stanton Jones answered phone calls about predicted rain with the response, "It looks like it will be clear!"

Clear for what? For the half-hour needed to celebrate the groundbreaking for the Wade Center's long-anticipated facility addition, the Bakke Auditorium.

Stanley and Jeannette Bakke have supported the mission and work of the Wade Center since before the collection was given that name to honor the incredible generosity of the family and friends of Marion E. Wade, founder and president of ServiceMaster. The Bakkes were students of Dr. Clyde Kilby at Wheaton College. After they graduated in 1961, they developed a friendship with both Dr. Kilby and his wife, Martha, that endured until both Kilbys passed away. Jeannette's dissertation, "The Lion and the Lamb and the Children: Christian Childhood Education through the Chronicles of Narnia," is part of the Wade Center's holdings, and Stan has been on the Wade Center Board (formerly the Wade Center Steering Committee) since 2006.

"It was wonderful," says Jeannette Bakke, "to hear and see Clyde Kilby's enthusiasm and vision as he began asking for materials first related to C.S. Lewis and then from the other authors and from those who held their

papers. The collection was first housed in the west wing of Blanchard Hall (in the English Department), and then in the Library and now in the Wade Center."

In 2004 the Bakkes initiated the hospitality fund "Martha's Table" to honor the legacy of the warm generosity they experienced in Clyde and Martha's home, and

in 2006 they spearheaded a 1961 class gift to purchase an audio-visual kiosk and a large display case for the museum. The auditorium is the Bakkes' most recent and generous investment in the Wade Center. Through their long association with the Wade they were aware of the need for a larger space to accommodate the growing numbers of attendees for Wade-sponsored events and educational programs. Stan and Jeannette are grateful that God has provided the means for them to make a substan-

tial donation. An anonymous donor has also contributed a significant supporting gift.

Wheaton College Architect Bruce Koeningsburg, designer Britta Wallbaum, and architect Terry Oppermann have worked closely with the Bakkes and Wade Center Acting Director Marjorie Mead to finalize plans for the auditorium to be aesthetically pleasing and consistent with the current design of the Wade. Most importantly, the plans reflect the Wade Center's needs and desires for the growth of its public educational programming.



*Friends of the Wade
Stan and Jeannette Bakke, with a
portrait of Clyde S. Kilby done by
Deborah Beisner.*

"The attitude that the spiritual and the secular worlds cannot be one and the same is shortsightedness in the sacrament of living. A thing becomes secular when you cut God out of it."

— Marion E. Wade



EDITING & DESIGN: Kendra Juskus

The Marion E. Wade Center
Wheaton College
Wheaton, Illinois 60187

Phone: 630-752-5908
Fax: 630-752-5459
E-mail: wade@wheaton.edu
www.wheaton.edu/wadecenter



Exterior plans for the Bakke Auditorium, facing the building from the east. The addition is depicted in a darker shade here to distinguish it, but in its construction it will be consistent in color and building material with the existing Wade facility.

Since 2001, when the Wade's building was completed, Saturday morning reading groups, school field trip visits, college classes, and public lectures have taken place largely in the Wade's classroom, which can accommodate about 50 people. In recent years, some Wade events have been so popular that overflow attendees have had to sit in the entrance hall to the building, or the event has needed to be held in a different Wheaton College campus facility. The good news is that this growth in events and audiences indicates that these authors' writings continue to gain admirers and affect lives. But when a Wade event is held in a separate building, visitors aren't exposed to the extensive resources of the Wade itself, and the opportunity is missed to make a connection between a speaker's subject matter and the immediate availability of that material.

"The Wade Center is a crown jewel of Wheaton College," says Provost Jones. "The need for a larger

meeting space to accommodate groups comfortably has been apparent, and we are very grateful to the Bakkes and other donors for their generosity in making such a space a reality. We are delighted that construction on the auditorium will likely begin in September."

The Bakke Auditorium will be constructed off the back (the north end) of the current Wade Center facility and will be consistent in appearance with the English manor-house style of the rest of the building. It will comfortably accommodate 100 people, and will have moveable seats to create a more intimate atmosphere when desired, a speaker's podium with computer access, and a permanent projection screen. A kitchenette will afford the opportunity to cater event receptions with ease. Depending on time of day and what other activities might be taking place at the Wade, visitors will be able to access the auditorium for special events either through a new east-facing entrance that will be part of the addition, or by coming in through the Wade Center's

main entryway (on Lincoln Avenue) and entering the auditorium by a door near the Reading Room.

With this new space, expected to be completed in early 2015, the Wade looks forward to hosting more author-related events within its own doors and welcoming larger groups on a regular basis. We also anticipate using this space in collaboration with the rest of the Wheaton College community, opening our doors to select non-Wade events and thereby increasing our authors' exposure to new audiences.

Upcoming Event

We are pleased to announce the publication in fall 2014 of *The Pilgrim's Regress: The Wade Annotated Edition* (Eerdmans). Originally published in 1933, this was the first book C.S. Lewis wrote as a Christian. This Wade Center edition was edited by Dr. David C. Downing, who will join us on Friday, September 19 at 7:00 pm to celebrate the book's launch. He will give a talk, followed by a reception and book signing. We hope you can join us for this special event at the Wade. **W**



In short, this addition will enable the Wade Center's offerings to expand as we continue to invite people to benefit from the Wade's resources in the ambiance of a lovely auditorium.

True to predictions and prayers, though the day was overcast and chilly, no rain fell during the brief groundbreaking ceremony held behind the Wade Center on April 3rd. Wheaton College Vice President for Finance and Treasurer Dale Kemp spoke about the legacy and future of the Wade, and Professor Emerita Carol Kraft (representing the Wade Board) offered a prayer of blessing for the project before they both donned hard hats and joined Marjorie Mead and the Bakkes to dig a ceremonial first shovelful of dirt as part of the groundbreaking for the auditorium. We were sorry that Wade Board Member Lisa Welchert, who had planned to participate in the groundbreaking as the representative for the Wade family, was unable to attend the ceremony due to travel complications.

Prior to the outdoor ceremony, a gathering of local *Friends*, current and former Wade staff, Wade Board members, and Wheaton College administrative and faculty representatives marked the occasion with an intimate luncheon and program at Wheaton College's Harbor House, located across the street from the Wade. Wheaton College's Advancement department organized the event, which included remarks by Provost Jones, Marjorie Mead, and Stan Bakke, and a closing benediction from Jeannette Bakke. Guests viewed construction plans for the auditorium and reminisced about their own experiences attending events at the Wade or being blessed by the hospitality of the Kilbys or reading a book by one of the Wade authors for the first time. In her remarks, Marjorie Mead called the day "an occasion of great joy."

Stan Bakke's heartfelt comments included sweet memories of his and Jeannette's time with the Kilbys, and then transitioned into a meditative litany of gratitude for all those who have been fundamental in shaping the mission and work of

the Wade, from the Wade authors themselves, to Mary Wade and her foundational gift that enables the Wade

to exist in its present form, to all those present at the groundbreaking. "But for" all of these individuals, he repeated, "we would not be here today." He concluded: "But for the grace of God, none of us would be here today to celebrate the beginning of construction of the auditorium for the Marion E. Wade Center. Thanks be to God." **W**

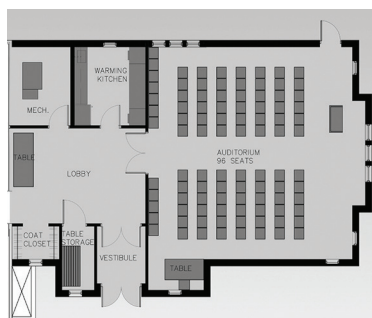

Plans of the interior of the Bakke Auditorium at the Marion E. Wade Center.

What's the Plan for the Bakke Auditorium?

- Book discussion groups
- Afternoon and evening lectures
- Presentations to visiting groups
- Performances (theater, music, etc.)
- Receptions and special events
- Select Wheaton College events

In Memoriam: Chris Mitchell



It is with great sadness that we announce the death of Christopher W. Mitchell, Director of the Marion E. Wade Center from 1994-2013. In addition to serving as Director, Chris held the Marion E. Wade Chair of Christian Thought at Wheaton

College from 2006 to 2013. Many of those who have visited or researched at the Wade over the years will recall Chris's warm welcome and affable manner. His love for God, family and friends, and great literature was palpable, and his enjoyment of life's good gifts was infectious.

Although Chris had retired from the Wade Center in 2013, he remained closely connected to the staff here and engaged with the scholarship of our authors. He will be dearly missed and lovingly remembered by each one of us and by the many students, colleagues, and friends his lively and gentle spirit touched, and most of all by his wife, Julie, and their four children and grandchildren.

For more on Chris's legacy and to view remembrances of his life and work, please visit our website: www.wheaton.edu/wadecenter. **W**

The Marion E. Wade Center

Wheaton College
Wheaton, Illinois 60187

Presorted
Non-Profit
U.S. Postage
PAID
Carol Stream, IL
Permit No. 6044

Spotlight on **SEVEN**

Volume 30

The 30th anniversary volume of *VII* honors the legacy of C.S. Lewis, without whose work Dr. Clyde S. Kilby would not have started the collection that is now the Marion E. Wade Center. Lewis died 50 years ago last November, and this volume memorializes him with five articles specific to his life and work. Of these, the autobiographical essay, “Early Prose Joy,” was written by Lewis as a young man and details the process of his conversion to theism. This essay has never been published until now. It is introduced and transcribed in this volume by Andrew Lazo, whose scholarship on the manuscript also illuminates evidence for a revised dating of Lewis’s conversion.

These pieces are followed by an early version of Walter Hooper’s chapter on *A Grief Observed*, which appeared in Hooper’s classic reference work, *C.S. Lewis: A Guide to His Life and Work*. Bruce R. Johnson transcribes and analyzes Lewis’s 1942 appearance on the BBC radio program, *Brains Trust*, a failure of public speaking that Lewis used to his advantage in later presentations. Finally, Suzanne Rosenthal Shumway explores the theme of gender in Lewis’s novel, *Till We Have Faces*.

If you haven’t already purchased this remarkable anniversary volume of *VII*, we invite you to do so at www.wheaton.edu/wadecenter/Journal-VII. **W**